

Tender Text

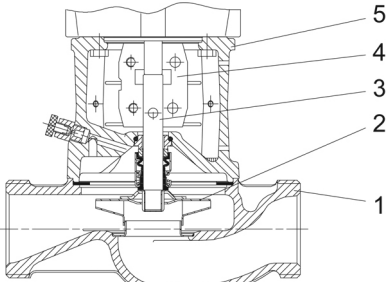

Note! Product picture may differ from actual product

Product No.: [98281476](#)

Qty.	Description
1	<p data-bbox="204 342 486 365">TP 25-50/2 A-O-A-BQQE</p>  <p data-bbox="204 660 470 683">Product No.: 98281476</p> <p data-bbox="204 721 1444 795">Single-stage, close-coupled, volute pump with in-line suction and discharge ports of identical diameter. The pump is of the top-pull-out design, i.e. the power head (motor, pump head and impeller) can be removed for maintenance or service while the pump housing remains in the pipework.</p> <p data-bbox="204 806 1412 855">The pump is fitted with an unbalanced rubber bellows seal. The shaft seal is according to EN 12756. Pipework connection is via PN 10 union connections (ISO 228-1).</p> <p data-bbox="204 866 833 889">The pump is fitted with a fan-cooled asynchronous motor.</p> <p data-bbox="204 922 518 952">Further product details</p> <p data-bbox="204 958 284 987">Pump</p> <p data-bbox="204 994 1136 1016">Pump housing and pump head are electrocoated to improve the corrosion resistance.</p> <p data-bbox="204 1023 466 1046">Electrocoating includes:</p> <ol data-bbox="204 1052 694 1169" style="list-style-type: none"> 1) Alkaline-based cleaning. 2) Pretreatment with zinc phosphate coating. 3) Cathodic electrocoating (epoxy). 4) Curing of paint film at 200-250 °C.  <ol data-bbox="204 1505 391 1650" style="list-style-type: none"> 1: Pump housing 2: Impeller 3: Shaft 4: Coupling 5: Pump head <p data-bbox="204 1684 1404 1758">The pump housing is provided with a replaceable stainless steel/PTFE neck ring to reduce the amount of liquid running from the discharge side of the impeller to the suction side. The impeller is secured with a split cone pressed onto the shaft.</p> <p data-bbox="204 1796 1444 1870">The pump is fitted with an unbalanced rubber bellows seal with torque transmission across the spring and around the bellows. Due to the bellows, the seal does not wear the shaft, and the axial movement is not prevented by deposits on the shaft.</p> <p data-bbox="204 1886 347 1908">Primary seal:</p> <ul data-bbox="239 1915 801 1966" style="list-style-type: none"> • Rotating seal ring material: silicon carbide (SiC) • Stationary seat material: silicon carbide (SiC) <p data-bbox="204 1973 1401 2022">This material pairing is used where higher corrosion resistance is required. The high hardness of this material pairing offers good resistance against abrasive particles.</p> <p data-bbox="204 2029 865 2051">Secondary seal material: EPDM (ethylene-propylene rubber)</p> <p data-bbox="204 2058 1098 2080">EPDM has excellent resistance to hot water. EPDM is not suitable for mineral oils.</p>

Qty.	Description
	<p>A circulation of liquid through the duct of the air vent screw ensures lubrication and cooling of the shaft seal. The motor stool forms connection between the pump housing and the motor, and is equipped with a manual air vent screw for venting of the pump housing and the shaft seal chamber. The sealing between motor stool and pump housing is an O-ring or a flat gasket.</p> <p>The central part of the motor stool is provided with guards for protection against the shaft and coupling. Motor and pump shaft are connected via a shell coupling.</p> <p>Motor</p> <p>The motor is a totally enclosed, fan-cooled motor with principal dimensions to IEC and DIN standards. Electrical tolerances comply with IEC 60034.</p> <p>The motor is flange-mounted with tapped-hole flange (FT).</p> <p>Motor-mounting designation in accordance with IEC 60034-7: IM B 14, IM V 18 (Code I) / IM 3601, IM 3611 (Code II).</p> <p>The motor does not incorporate motor protection and must be connected to a motor-protective circuit breaker which can be manually reset. The motor-protective circuit breaker must be set according to the rated current of the motor (I1/1).</p> <p>Technical data</p> <p>Liquid:</p> <p>Pumped liquid: Water</p> <p>Liquid temperature range: -25 .. 120 °C</p> <p>Selected liquid temperature: 20 °C</p> <p>Density at selected liquid temperature: 998.2 kg/m³</p> <p>Technical:</p> <p>Pump speed on which pump data are based: 2800 rpm</p> <p>Rated flow: 3.72 m³/h</p> <p>Rated head: 2.7 m</p> <p>Actual impeller diameter: 68 mm</p> <p>Primary shaft seal: BQQE</p> <p>Curve tolerance: ISO9906:2012 3B</p> <p>Materials:</p> <p>Pump housing: Cast iron EN-JL1020 ASTM A48-25B</p> <p>Impeller: Composite PES/PP 30% GF</p> <p>Installation:</p> <p>Range of ambient temperature: -30 .. 40 °C</p> <p>Maximum operating pressure: 10 bar</p> <p>Flange standard: UNION</p> <p>Pipe connection: G 1 1/2</p> <p>Pressure rating: PN 10</p> <p>Port-to-port length: 180 mm</p> <p>Flange size for motor: FT75</p> <p>Electrical data:</p> <p>Motor type: SIEMENS</p> <p>Rated power - P2: 0.12 kW</p> <p>Power (P2) required by pump: 0.12 kW</p> <p>Mains frequency: 50 Hz</p> <p>Rated voltage: 3 x 220-240D/380-415Y V</p> <p>Rated current: 0.59/0.34 A</p> <p>Cos phi - power factor: 0.80-0.72</p> <p>Rated speed: 2800-2850 rpm</p>



Company name:

Created by:

Phone:

Date:

03/08/2019

Qty.	Description
	Number of poles: 2
	Enclosure class (IEC 34-5): 55 Dust/Jetting
	Insulation class (IEC 85): F
	Motor No: 81602312
	Others:
	ErP status: EuP Standalone/Prod.
	Net weight: 8 kg
	Gross weight: 9 kg
	Shipping volume: 0.026 m ³
	Danish VVS No.: 381810050
	Norwegian NRF no.: 9043509

98281476 TP 25-50/2 A-O-A-BQQE 50 Hz

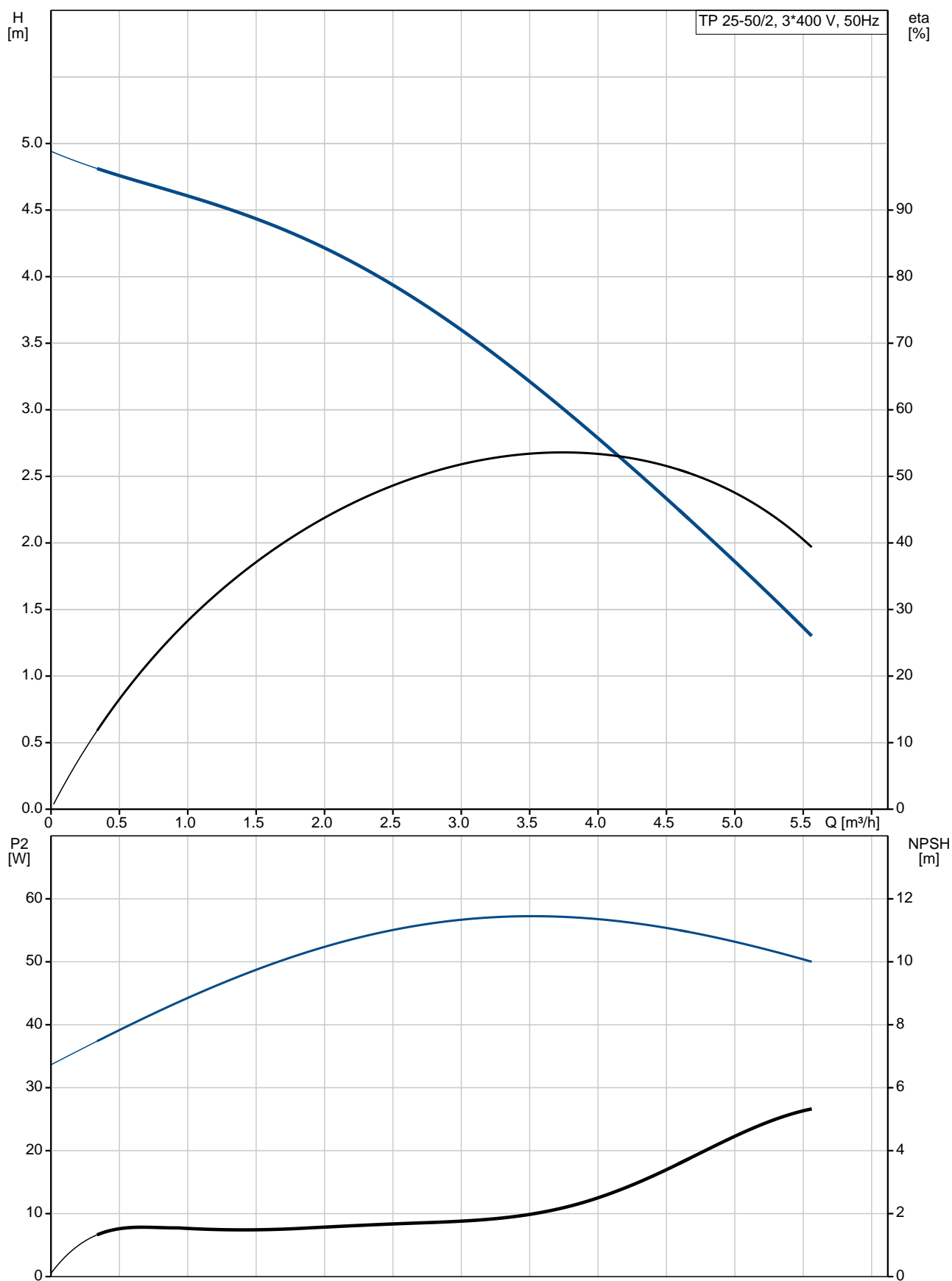

Description	Value
General information:	
Product name:	TP 25-50/2 A-O-A-BQQE
Product No:	98281476
EAN number:	5711492389355
Technical:	
Pump speed on which pump data are based:	2800 rpm
Rated flow:	3.72 m ³ /h
Rated head:	2.7 m
Head max:	50 dm
Actual impeller diameter:	68 mm
Primary shaft seal:	BQQE
Curve tolerance:	ISO9906:2012 3B
Pump version:	A
Model:	B
Materials:	
Pump housing:	Cast iron
	EN-JL1020
	ASTM A48-25B
Impeller:	Composite PES/PP 30% GF
Material code:	A
Installation:	
Range of ambient temperature:	-30 .. 40 °C
Maximum operating pressure:	10 bar
Flange standard:	UNION
Pipe connection:	G 1 1/2
Pressure rating:	PN 10
Port-to-port length:	180 mm
Flange size for motor:	FT75
Connect code:	O
Liquid:	
Pumped liquid:	Water
Liquid temperature range:	-25 .. 120 °C
Selected liquid temperature:	20 °C
Density at selected liquid temperature:	998.2 kg/m ³
Electrical data:	
Motor type:	SIEMENS
Rated power - P2:	0.12 kW
Power (P2) required by pump:	0.12 kW
Mains frequency:	50 Hz
Rated voltage:	3 x 220-240D/380-415Y V
Rated current:	0.59/0.34 A
Cos phi - power factor:	0.80-0.72
Rated speed:	2800-2850 rpm
Number of poles:	2
Enclosure class (IEC 34-5):	55 Dust/Jetting
Insulation class (IEC 85):	F
Motor protec:	NONE
Motor No:	81602312
Others:	
ErP status:	EuP Standalone/Prod.
Net weight:	8 kg
Gross weight:	9 kg
Shipping volume:	0.026 m ³
Danish VVS No.:	381810050
Norwegian NRF no.:	9043509

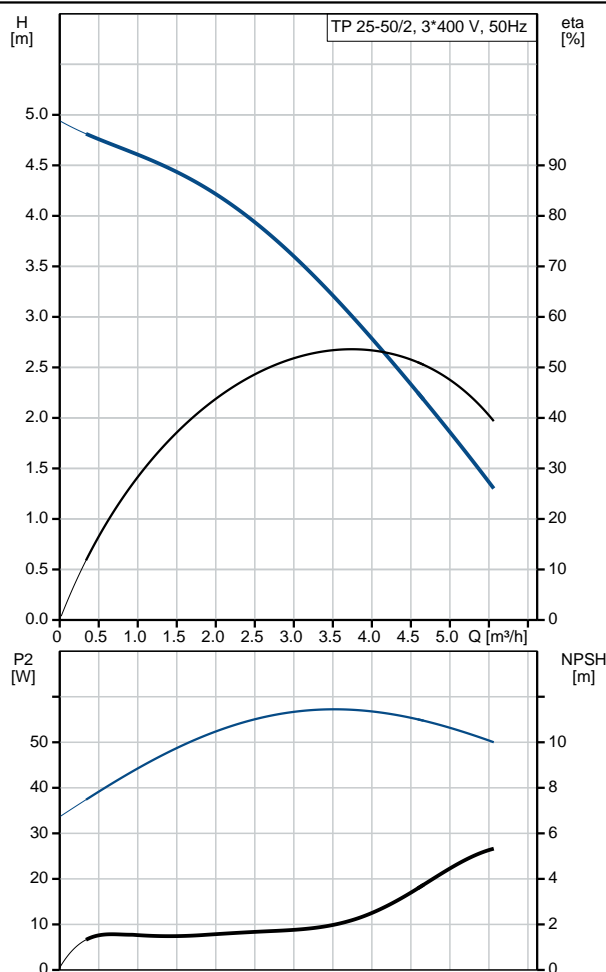

98281476 TP 25-50/2 A-O-A-BQQE 50 Hz

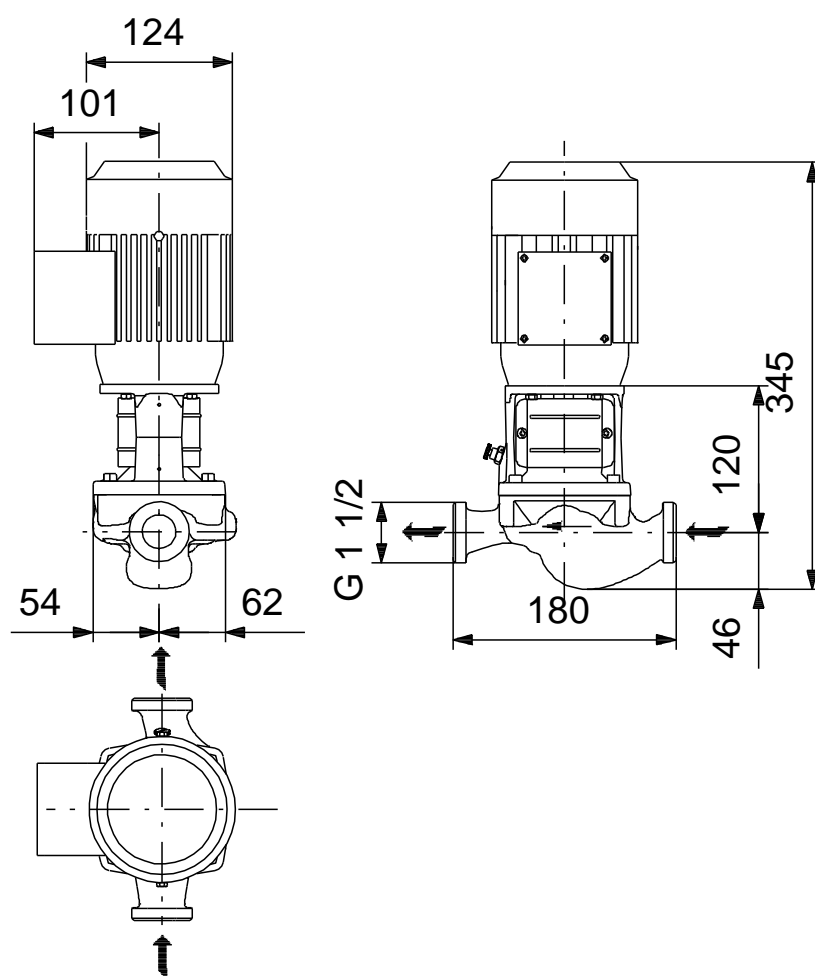

Note! All units are in [mm] unless others are stated.
Disclaimer: This simplified dimensional drawing does not show all details.

98281476 TP 25-50/2 A-O-A-BQQE 50 Hz

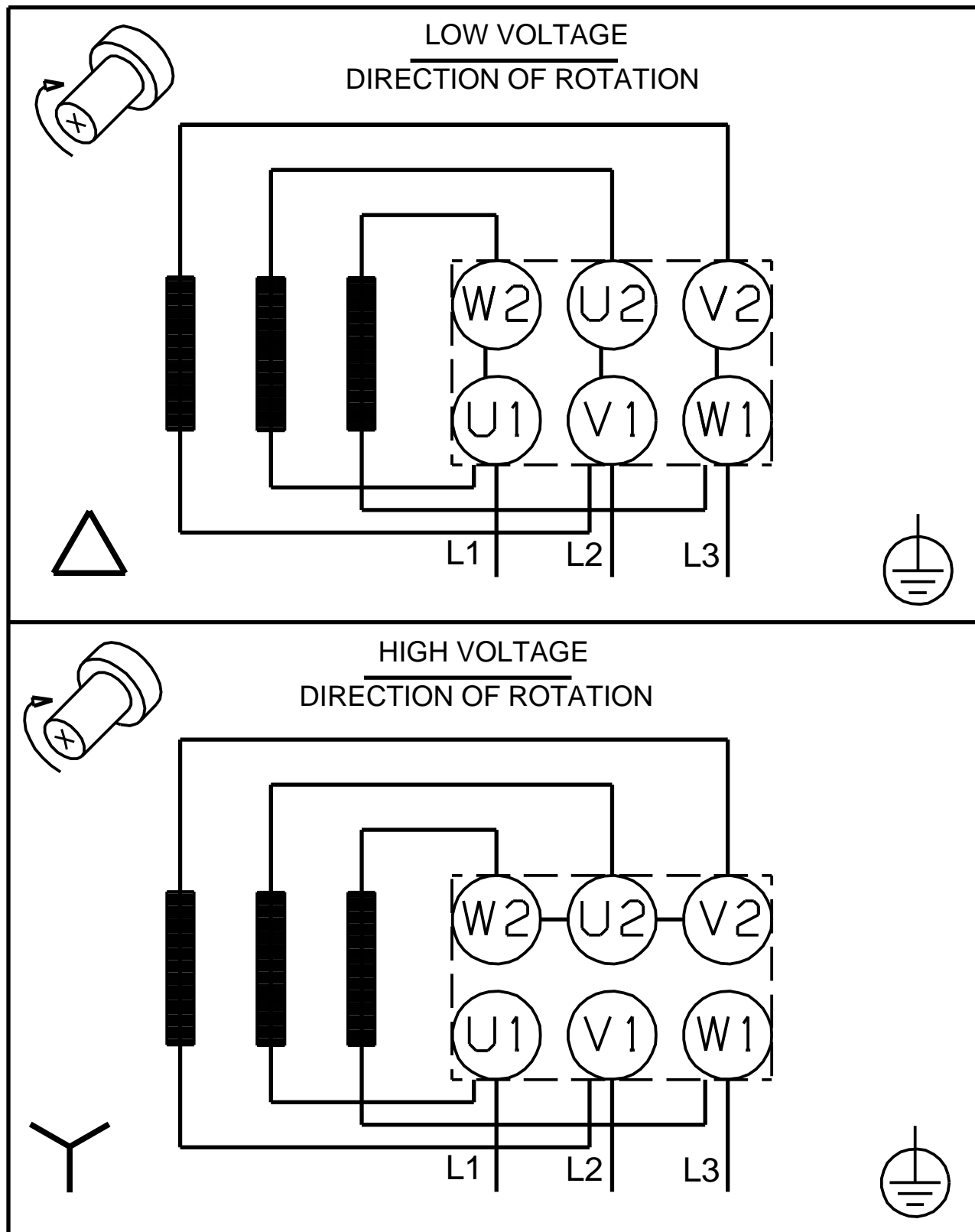

Note! All units are in [mm] unless others are stated.