

Data sheet: Stratos 25/1-6

Hydraulic data

Maximum operating pressure P_N	16 bar
Max. delivery head H	6.00 m
Max. volume flow Q	7.6 m³/h
Minimum suction head at 50 °C	3
Minimum suction head at 95 °C	10
Minimum suction head at 110 °C	16
Min. fluid temperature T	-10 °C
Max. fluid temperature T	110 °C
Min. ambient temperature T	-10 °C
Max. ambient temperature T	40 °C

Materials

Pump housing	5.1300, EN-GJL-200
Impeller	PPE-GF30
Shaft	1.4122, X39CrMo17-1
Bearing	Carbon graphite, all Carbon

Information for order placements

Net weight, approx. m	4 kg
Brand	Wilo
Product description	Stratos 25/1-6
Article number	2065097

Motor data

Energy efficiency index (EEI)	0.20
Mains connection	1~230 V \pm 10%, 50/60 Hz
Min current I_{min}	0.13 A
Max current I_{max}	0.70 A
Min. speed n_{min}	1400 rpm
Max. speed n_{max}	3400 rpm
Power consumption $P_{1 min}$	9.0 W
Power consumption $P_{1 max}$	80.0 W
Emitted interference	EN 61800-3;2004+A1;2012 /residential area (C1)
Interference resistance	EN 61800-3;2004+A1;2012 /industria l environment (C2)
Threaded cable connection	1 x PG7
Insulation class	F
Protection class	IPX4D

Installation dimensions

Pipe connection on the pressure side R_{PD}	G 1½
Pipe connection on the suction side R_{PS}	G 1½
Port-to-port length l_0	180 mm

Tender text: Stratos 25/1-6

Wilo-Stratos high-efficiency pump

electronically controlled,

Glandless circulation pump with minimum operating costs, for pipe installation. Can be used for all HVAC applications (-10 °C to +110 °C). With built-in electronic power control for constant/variable differential pressure. Standard-equipped thermal insulation shells. One-button manual operation level as standard, for:

- Pump On/Off
- Selecting the control mode:
 - dp-c (differential pressure constant)
 - dp-v (differential pressure variable)
 - dp-T (differential pressure temperature-controlled) by means of IR-Monitor/IR-Module/IR-Stick, Modbus, BACnet, LON or Can
 - Q-Limit to restrict the maximum volume flow (setting only via IR-Stick)
 - Manual control mode (setting constant speed)
- Automatic setback operation (self-learning)
- Setpoint or speed adjustment

Graphical pump display with rotatable display horizontal and vertical module mounting, for display of:

- Operating status
- Control mode
- Differential pressure or rotation speed setpoint
- Fault and alarm signals

Synchronous motor using ECM technology with very high efficiency and high starting torque, automatic deblocking function and built-in full motor protection.

Fault signal light, potential-free collective fault signal, infrared interface for wireless communication with Wilo IR-Monitor/IR-Stick operating and service device.

Plug-in slot for Wilo Stratos IF-modules with interfaces for building automation (BA) or dual pump management (accessories: IF-modules Stratos Modbus, BACnet, LON, CAN, PLR, Ext.Aus, Ext.Min, SBM, Ext.Aus/SBM or DP).

Pump housing made of cast iron with cataphoretic coating, impeller made of glass-fibre reinforced plastic, stainless steel shaft with metal impregnated carbon plain bearings.

For flange-end pumps - flange versions:

- Standard version for pumps DN 32 to DN 65: Combination flange PN 6/10 (flange PN 16 acc. to EN 1092-2) for counter flanges PN 6 and PN 16
- Standard version for pumps DN 80 / DN 100: Flange PN 6 (configured for PN 16 acc. to EN 1092-2) for counter flange PN 6
- Special version for pumps DN 32 to DN 100: Flange PN 16 (acc. to EN 1092-2) for counter flange PN 16

Operating data		Motor data	
Fluid media	Water	Energy efficiency index (EEI)	0.20
Maximum operating pressure <i>PN</i>	16 bar	Emitted interference	EN 61800-3;2004+A1;2012 /residential area (C1)
Minimum suction head at 50 °C	3	Interference resistance	EN 61800-3;2004+A1;2012 /industrial environment (C2)
Minimum suction head at 95 °C	10	Mains connection	1~230 V, 50/60 Hz
Minimum suction head at 110 °C	16	Power consumption $P_{1\max}$	80.0 W
		Min. speed n_{\min}	1400 rpm
		Max. speed n_{\max}	3400 rpm
		Protection class motor	IPX4D
		Threaded cable connection	1 x PG7
Materials		Installation dimensions	
Pump housing	5.1300, EN-GJL-200	Pipe connection on the suction side <i>RPS</i>	G 1½
Impeller	PPE-GF30	Pipe connection on the pressure side <i>RPD</i>	G 1½
Shaft	1.4122, X39CrMo17-1	Port-to-port length <i>l0</i>	180 mm
Bearing	Carbon graphite, all Carbon		
Information for order placements			
Brand	Wilo		
Product description	Stratos 25/1-6		
Net weight, approx. <i>m</i>	4 kg		
Article number	2065097		

Dimensions and dimensions drawings: Stratos 25/1-6

Stratos (2065097)

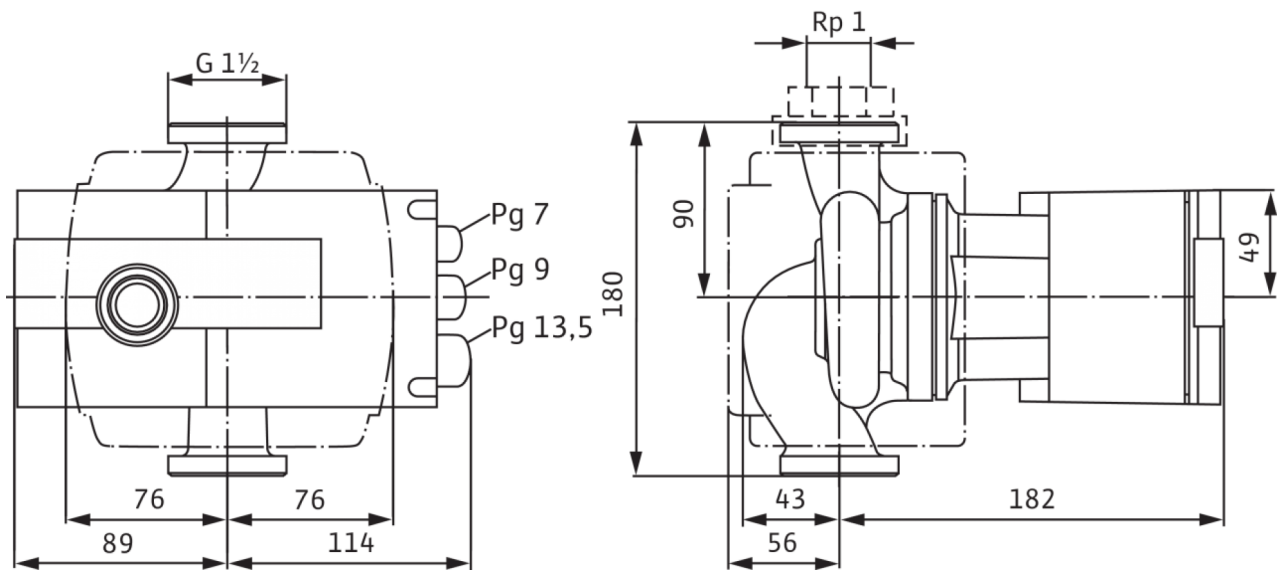

Pump curves: Stratos 25/1-6

Stratos 25/1-6, 30/1-6

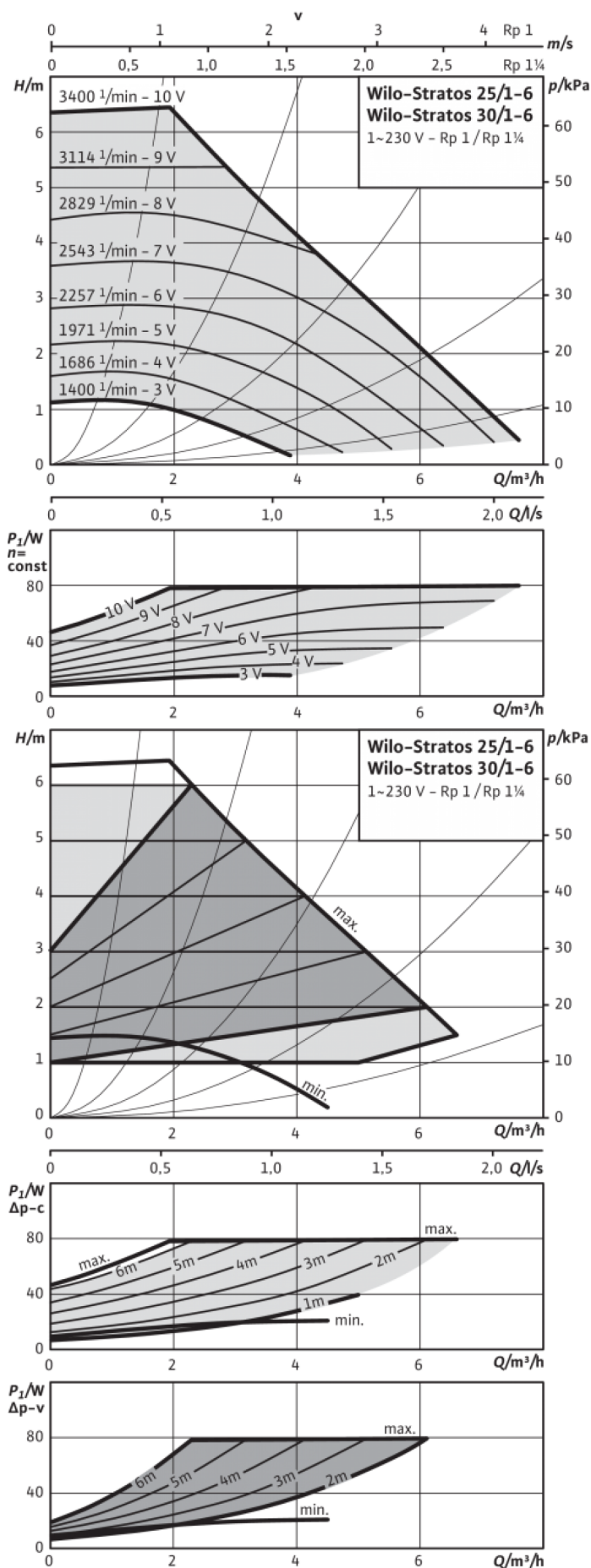

Wiring diagram: Stratos 25/1-6

1~230V, 50/60 Hz; 1~230 V, 50/60 Hz

1~ 230 V, 50/60 Hz

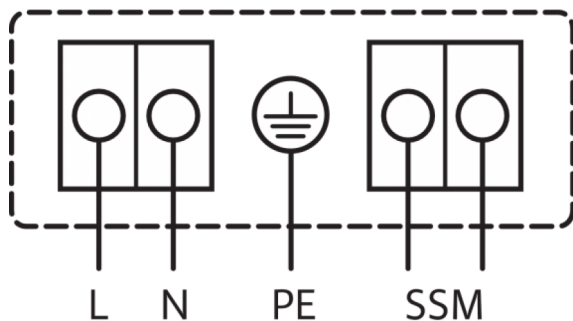

SSM:

Standard: 1~230 V, 50/60 Hz

Option: 3~230 V, 50/60 Hz

3~230 V, 50/60 Hz

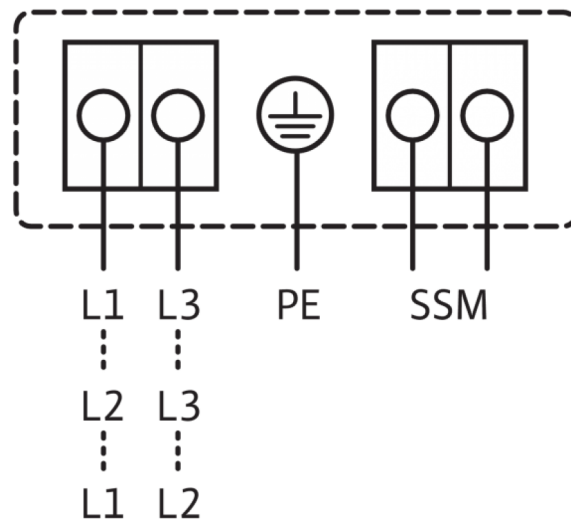

Collective fault signal

(NC contact in accordance with VDI 3814, load capacity 1 A, 250 V ~)